



Low Voltage Fuses

European NH Knife Blade Fuse System

Article	Description	Selection Guide	Technical Data
aM - 690V_{AC} - IEC - Live Metal Gripping Lugs			
2047708	NH000	585	587 - 588
2020908	NH00		
2021008	NH0		
2021108	NH1		
2021208	NH2		
2021308	NH3	586	
2022708	NH4a	586	
2022508	NH4		
aM - 1000V_{AC} - IEC - Live Metal Gripping Lugs			
2038608	NH000M	589	589 - 590
2038908	NH00M		

NH	Rated Voltage [U _n] 690V _{AC}	Rated Breaking Test Capacity 120kA	Rated Breaking Test Voltage 500V _{AC}	Class aM	Standard(s) IEC 60269-1 VDE 0636 Part 2011
-----------	---	--	--	--------------------	---

000, 00, 0, 1 & 2

Live Metal Removal Tags

Rated Current I _n [A]	Size 000 W/ Combi-Indicator Article Number	Size 00 W/ Combi-Indicator Article Number	Size 0 W/ Combi-Indicator Article Number	Size 1 W/ Combi-Indicator Article Number	Size 2 W/ Combi-Indicator Article Number	Size 2 W/ Combi-Indicator Article Number
6	2047708.6	—	—	—	—	—
10	2047708.10	—	—	—	—	—
16	2047708.16	—	2021008.16	2021108.16	—	—
20	2047708.20	—	2021008.20	2021108.20	—	—
25	2047708.25	—	2021008.25	2021108.25	—	—
32	2047708.32	—	2021008.32	2021108.32	—	—
35	2047708.35	—	2021008.35	2021108.35	2021208.35	—
40	2047708.40	—	2021008.40	2021108.40	2021208.40	—
50	2047708.50	—	2021008.50	2021108.50	2021208.50	—
63	—	2020908.63	2021008.63	2021108.63	2021208.63	—
80	—	2020908.80	2021008.80	2021108.80	2021208.80	—
100	—	2020908.100	2021008.100	2021108.100	2021208.100	—
125	—	2020908.125	2021008.125	2021108.125	2021208.125	—
160	—	—	2021008.160	2021108.160	2021208.160	—
200	—	—	—	2021108.200	2021208.200	—
224	—	—	—	2021108.224	2021208.224	—
250	—	—	—	2021108.250	2021208.250	—
315	—	—	—	—	—	2021208.315
355	—	—	—	—	—	2021208.355
400	—	—	—	—	—	2021208.400
Weight [kg per 1]						
	0.13	0.24	0.28	0.41	0.48	0.86
Units per Package						
	3	3	3	3	3	3
Dimensions [in / mm]						
a ₁	3.07 / 78	3.07 / 78	4.92 / 125	5.30 / 135	5.90 / 150	5.90 / 150
a ₅	1.85 / 47	1.85 / 47	2.56 / 65	2.56 / 65	2.56 / 65	2.56 / 65
b ₁	0.60 / 15	0.60 / 15	0.60 / 15	0.79 / 20	0.79 / 20	1.02 / 26
c ₁	1.38 / 35	1.38 / 35	1.38 / 35	1.57 / 40	1.90 / 48	1.90 / 48
e ₁	1.60 / 40.5	1.80 / 46	1.80 / 46	2.03 / 51.5	2.03 / 51.5	2.32 / 59
e ₂	0.81 / 20.5	1.16 / 29.5	1.16 / 29.5	1.65 / 42	1.65 / 42	2.09 / 53
e ₄	0.24 / 6	0.24 / 6	0.24 / 6	0.24 / 6	0.24 / 6	0.24 / 6
f	0.28 / 7	0.50 / 13	0.50 / 13	0.55 / 14	0.55 / 14	0.55 / 14

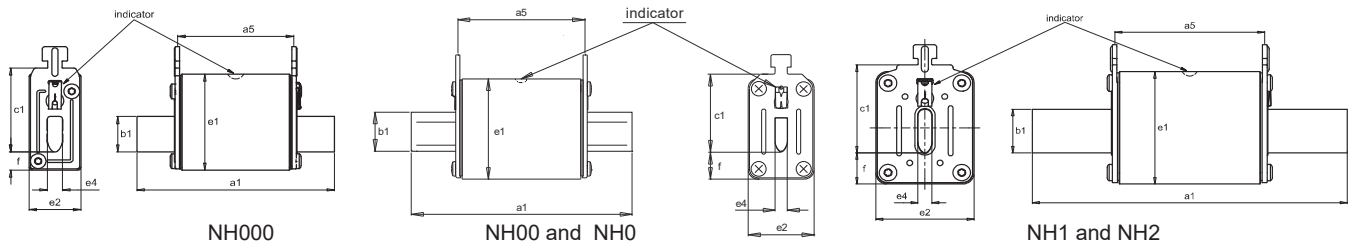

Accessories

Article Description	Article Number	Page	Article Description	Article Number	Page
Fuse base 1-Pole, NH000/00	2100101	597	Microswitch (red hammer)	2800202	596
Fuse base 3-Pole, NH000/00	2100103		Fuse base 1-Pole, NH2	2100401	600
Fuse base 1-Pole, NH0	2100204	598	Fuse base 3-Pole, NH2	2100403	
Fuse base 1-Pole, NH1	2100301		599	Fuse insertion / removal grip handle	
Fuse base 3-Pole, NH1	2100303	Standard (NH000-NH3)		2200102	604
		W/ leather sleeve (NH000-NH3)		2200105	

NH	Rated Voltage [U _n] 690V _{AC}	Rated Breaking Test Capacity 120kA	Rated Breaking Test Voltage 500V _{AC}	Class aM	Standard(s) IEC 60269-1 VDE 0636 Part 2011
-----------	---	--	--	--------------------	---

3, 4a & 4 Live Metal Removal Tags

Rated Current I _n [A]	Size 3 W/ Combi-Indicator Article Number	Size 3 W/ Combi-Indicator Article Number	Size 3 W/ Combi-Indicator Article Number	Size 4a W/ Top-Indicator Article Number	Size 4 W/ Top-Indicator Article Number
250	2021308.250	—	—	—	—
315	2021308.315	—	—	—	—
355	—	2021308.355	—	—	—
400	—	2021308.400	—	2022708.400	2022508.400
500	—	—	2021308.500	2022708.500	2022508.500
630	—	—	2021308.630	2022708.630	2022508.630
800	—	—	—	2022708.800	2022508.800
1 000	—	—	—	2022708.1000	2022508.1000
Weight [kg per 1]					
	0.86	1.10	1.40	2.63	2.25
Units per Package					
	3	1	1	1	1
Dimensions [in / mm]					
a₁	5.90 / 150	5.90 / 150	5.90 / 150	7.87 / 200	7.87 / 200
a₅	2.56 / 65	2.56 / 65	2.56 / 65	3.42 / 87	2.56 / 65
b₁	1.02 / 26	1.26 / 32	1.26 / 32	1.97 / 50	1.97 / 50
c₁	2.36 / 60	2.36 / 60	2.36 / 60	3.35 / 85	3.35 / 85
e₁	2.32 / 59	2.87 / 73	2.87 / 73	4.25 / 108	4.25 / 108
e₂	2.10 / 53	2.56 / 65	2.87 / 73	3.94 / 100	3.94 / 100
e₄	0.24 / 6	0.24 / 6	0.24 / 6	0.24 / 6	0.31 / 8
f	0.55 / 14	0.67 / 17	0.63 / 16	1.10 / 28	1.10 / 28
h					5.91 / 150
i					0.63 / 16

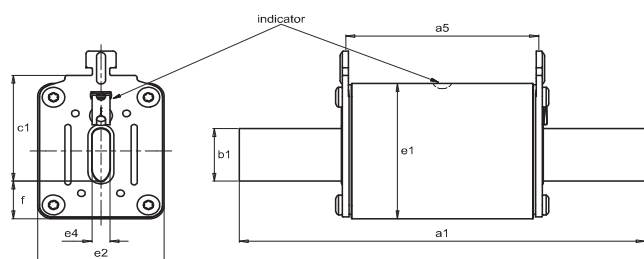

NH2 and NH3

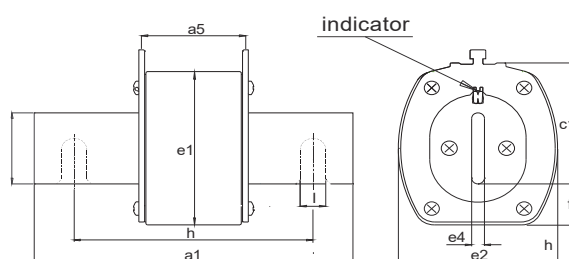

NH4a and NH4

Accessories

Article Description	Article Number	Page	Article Description	Article Number	Page
Fuse base 1-Pole, NH3	2100501	601	Microswitch (red hammer)	2800202	598
Fuse base 1-Pole, NH4a	2112002	602	Grip handle, insertion / removal tool		
Fuse base 1-Pole, NH4	2100601		Standard (NH000-NH3)	2200102	604
Fuse base 1-Pole, NH4	2100605		W/ leather sleeve (NH000-NH3)	2200105	
			W/ leather sleeve (NH4 & NH4a)	2212001	



FUSES

NH	Rated Voltage	Rated Breaking Test		Class	Standard(s)
	[U _n] 690V _{AC}	Capacity 120kA	Voltage 500V _{AC}		

3, 4a & 4 Live Metal Removal Tags

Rated current I _n [A]	Pre-arcing I ² t [A ² s]	Total I ² t I @ 254V _{AC} [A ² s]	Total I ² t @ 440V _{AC} [A ² s]	Total I ² t @ 500V _{AC} [A ² s]	Total I ² t @ 690V _{AC} [A ² s]	Power loss [W]							
						NH000	NH00	NH0	NH1	NH2	NH3	Size 4a	Size 4
16	476	780	950	1 280	1 800	0.8	—	1.0	1.0	—	—	—	—
20	760	910	1 480	1 670	3 500	—	—	1.1	1.1	—	—	—	—
25	1 440	1 780	2 890	3 270	5 500	1.4	—	1.4	1.4	—	—	—	—
32	2 600	3 360	5 630	6 360	9 500	1.6	—	1.9	1.9	—	—	—	—
35	3 100	4 770	7 610	8 600	11 500	1.8	1.8	2.1	2.1	—	—	—	—
40	4 700	6 750	11 300	12 800	14 500	2.0	2.0	2.4	2.4	2.3	—	—	—
50	5 900	8 340	13 600	15 300	28 000	2.4	2.0	2.8	2.8	2.7	—	—	—
63	10 300	16 200	26 400	30 700	39 000	—	3.2	3.8	3.8	3.0	—	—	—
80	17 300	27 200	45 500	51 400	68 000	—	4.2	4.8	4.8	4.8	—	—	—
100	28 900	45 500	88 600	97 000	110 000	—	5.2	—	—	5.3	—	—	—
125	44 400	78 600	127 500	157 600	160 000	—	6.6	7.8	7.8	—	—	—	—
160	78 500	139 600	226 600	280 200	290 000	—	9.0	—	—	—	—	—	—
200	157 600	248 200	390 900	483 400	420 000	—	—	—	—	—	—	—	—
224	194 800	297 600	483 400	615 000	520 000	—	—	—	—	—	—	—	—
250	240 900	368 000	616 000	761 000	640 000	—	—	—	—	—	22	—	—
315	513 000	716 000	1 164 000	1 438 000	1 200 000	—	—	—	—	—	25	—	—
355	616 000	859 000	1 483 000	1 725 000	1 650 000	—	—	—	—	—	26	—	—
400	859 000	1 236 000	2 008 000	2 558 000	2 000 000	—	—	—	—	—	28	34	31
500	1 130 000	1 670 000	2 800 000	3 360 000	2 700 000	—	—	—	—	—	35	44	40
630	1 950 000	2 980 000	4 840 000	6 000 000	4 000 000	—	—	—	—	—	40	53	48
800	3 700 000	5 450 000	8 900 000	11 300 000	10 500 000	—	—	—	—	—	—	64	58
1 000	4 510 000	7 460 000	9 020 000	12 200 000	17 000 000	—	—	—	—	—	—	78	71
1 250	7 800 000	12 900 000	15 000 000	21 100 000	29 000 000	—	—	—	—	—	—	100	92



NH	Rated Voltage [U _n] 690V _{AC}	Rated Breaking Test Capacity 120kA	Rated Breaking Test Voltage 500V _{AC}	Class aM	Standard(s) IEC 60269-1 VDE 0636 Part 2011
3, 4a & 4					

Time-Current Characteristics

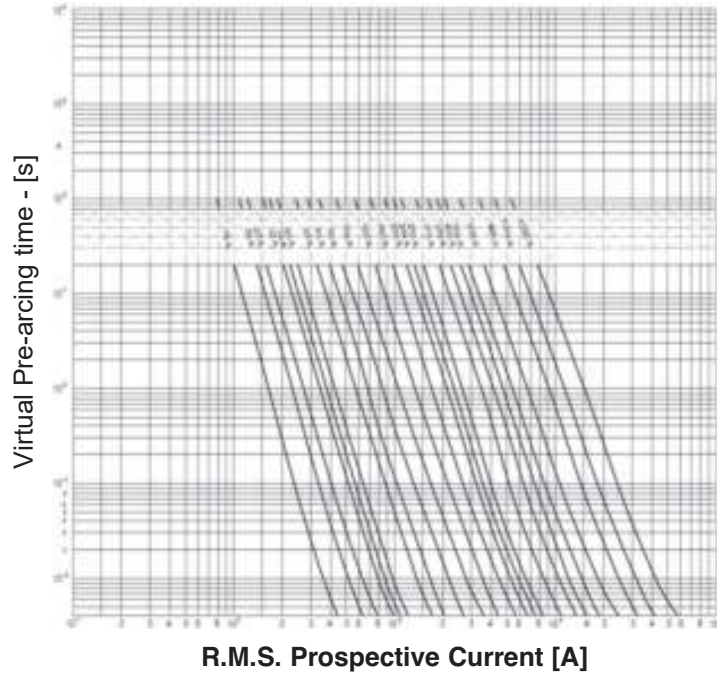

Cutoff Current Characteristics

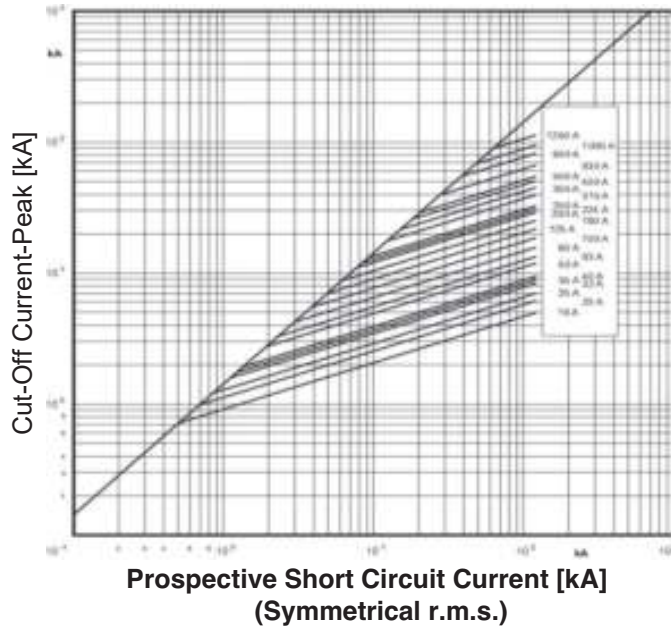

Full size graphs available upon request

NH	Rated Voltage	Rated Breaking	Test	Class	Standard(s)
	[U _n] 1000V _{AC}	Capacity 25kA - 00M / 63kA - 00M	Voltage 760V _{AC}	aM	DIN 43620 Part 5 VDE 0636 Part 2011
000M & 00M					
Live Metal Removal Tags					

Rated Current I _n [A]	Size 000M W/ Top Indicator Article Number	Size 00M W/ Top Indicator Article Number	Pre-arcing I ² t [A ² s]	Total I ² t @ 760Vac [A ² s]	Power Loss [W]
16	2038608.16	—	520	2 100	0.9
20	2038608.20	—	930	3 700	1.3
25	2038608.25	—	1 450	5 800	1.8
35	2038608.35	—	2 450	9 800	2.1
50	2038608.50	—	5 500	22 000	2.5
63	2038608.63	—	10 500	42 000	3.5
80	2038608.80	—	13 000	52 000	5.8
100	2038608.100	—	19 000	76 000	8.0
125	—	2038908.125	30 000	120 000	13
160	—	2038908.160	53 000	212 000	17
Weight [kg per 1]					
	0.18	0.28			
Units per Package					
	3				
Dimensions [in / mm]					
a ₁	4.33 / 110	4.61 / 117			
a ₅	3.07 / 78	3.35 / 85			
b ₁	1.02 / 15	1.26 / 15			
c ₁	1.38 / 35	1.38 / 35			
e ₁	1.60 / 40.5	1.80 / 46			
e ₂	0.80 / 20.5	1.16 / 29.5			
e ₄	0.24 / 6	0.24 / 6			
f	0.28 / 7	0.54 / 13.5			

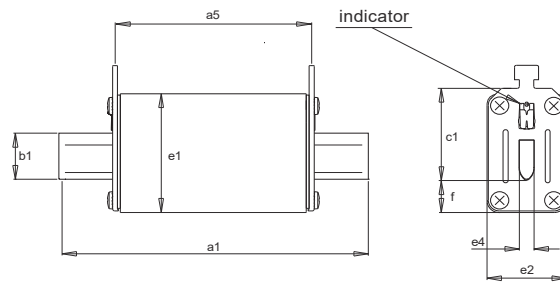

NH000 and NH00

Accessories

Article Description	Article Number	Page	Article Description	Article Number	Page
Fuse base 1-Pole, NH00C	2138601	603	Microswitch (red hammer)	2800202	596
Fuse base 1-Pole, NH00	2138901		Grip handle, insertion / removal tool		
			Standard (NH000-NH3)	2203101	604
			W/ leather sleeve (NH000-NH3)	2203102	

NH	Rated Voltage [U _n] 1000V _{AC}	Rated Breaking Capacity 25kA - 00M / 63kA - 00M	Test Voltage 760V _{AC}	Class aM	Standard(s) DIN 43620 Part 5 VDE 0636 Part 2011
000M & 00M					

Time-Current Characteristics

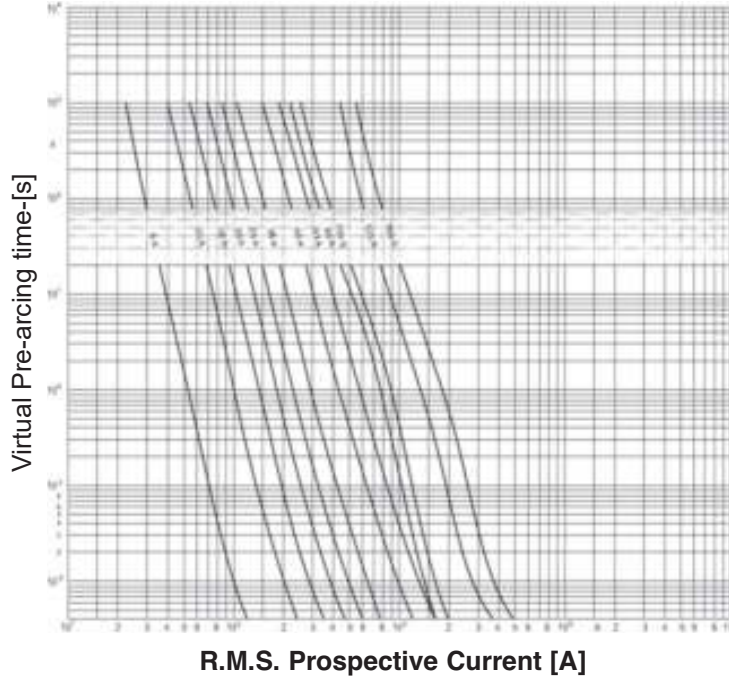

Cutoff Current Characteristics

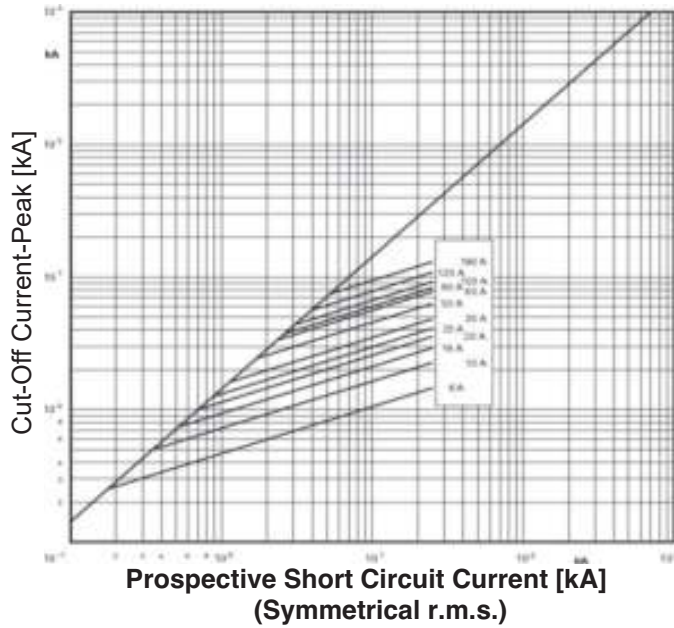

Full size graphs available upon request